

AGILA

2441UAP200R05-28 Kickstop

EAN 4031582300512

Swivel castor with directional lock, housing made of pressed steel, bright zinc plated, blue passivated, covered precision swivel bearing, hardened balls and tracks, bearing sleeve welded to fork, wheel axle with nut, solid plug fitting. Wheel centre made of Polyamide, Tread: Polyurethane, precision ball bearing, with threadguards



BETTER MOBILITY. BETTER LIFE.



Picture may differ from original product

Technical Data

Wheel diameter	200 mm
Wheel width	32 mm
Bolt-Ø	28 mm
Bolt length	45 mm
Offset	62 mm
Swivel Interference	324 mm
Overall height	240 mm
Temperature	- 40 / + 80 °C
Standard	EN 12530
Weight	2.036 kg
Hardness of tread	Shore D 40
Load capacity	150 kg
Load capacity (static)	300 kg

Dimensions

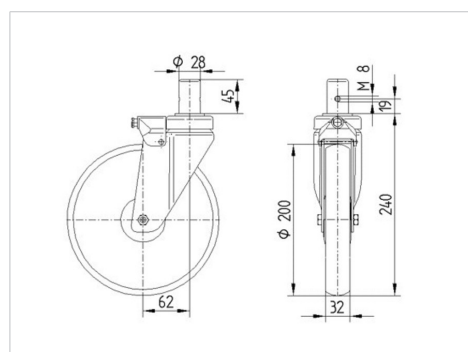

Advantages at a glance

Roll performance	● ● ● ○ ○
Movement noise	● ● ● ○ ○
Attrition	● ● ● ● ○
Corrosion resistance	● ● ● ○ ○