

AGILA

2475DIK050B10-11x31

EAN 4031582301687

Swivel castor with wheel brake, housing made of pressed steel, bright zinc plated, blue passivated, double ball bearing swivel head, wheel axle with nut, stem with circlip. Wheel centre made of pressed steel, Tread: solid rubber, grey non-marking, with threadguards, cone ball bearing



BETTER MOBILITY. BETTER LIFE.



Picture may differ from original product

Technical Data

Wheel diameter	50 mm
Wheel width	19 mm
Metal stem with circlip	11 x 31 mm
Offset	24 mm
Overall height	72 mm
Temperature	- 20 / + 85 °C
Standard	EN 12530
Weight	0.255 kg
Hardness of tread	Shore A 80
Load capacity	40 kg
Load capacity (static)	80 kg

Dimensions

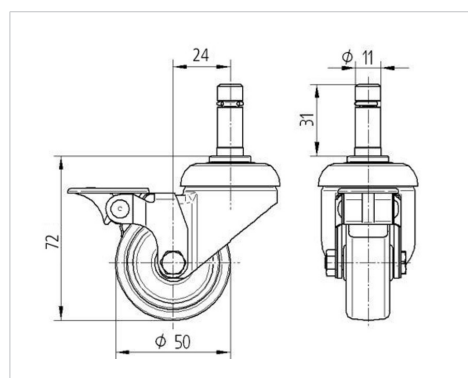

Structure & Mounting

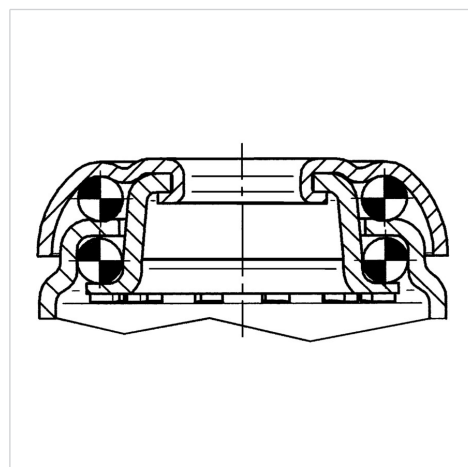

Advantages at a glance

Roll performance	● ● ● ○ ○
Movement noise	● ● ● ○ ○
Attrition	● ● ● ○ ○
Corrosion resistance	● ● ● ○ ○