

# AGILA

## 2475PJO050P30-11

EAN 4031582436365

Swivel castor with wheel brake, housing made of pressed steel, bright zinc plated, blue passivated, double ball bearing swivel head, bolt hole.

Wheel centre made of Polypropylene, Tread: TENTEprene (thermoplastic rubber), grey non-marking, plain bearing Castors can be mounted with standard screws; various length screws can be used.



BETTER MOBILITY. BETTER LIFE.



Picture may differ from original product

### Technical Data

Wheel diameter	50 mm
Wheel width	19 mm
Centre hole	11 mm
Offset	24 mm
Overall height	69 mm
Temperature	-20/+60 °C
Standard	EN 12530
Weight	0.159 kg
Swivel Radius	80 mm
Hardness of tread	Shore A 87
Load capacity	40 kg
Load capacity (static)	80 kg

### Advantages at a glance

Roll performance	● ● ● ○ ○
Movement noise	● ● ● ○ ○
Attrition	● ● ● ○ ○
Corrosion resistance	● ● ● ○ ○

### Dimensions

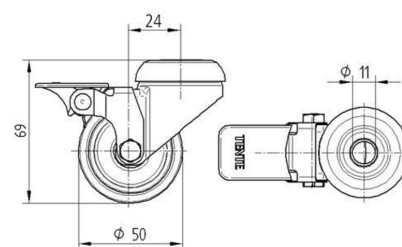

### Structure & Mounting

