

ALPHA

3476UFP200P67

EAN 4031582305012

Swivel caster with central lock, housing made of pressed steel, bright zinc plated, blue passivated, double ball bearing swivel head, wheel axle with nut, dustguard, plate fitting with integrated central lock. Wheel center made of Polyamide, Tread: elastic-tire, non-marking, precision ball bearing

Hint: The brake pedal is attached to the mounting plate. The swivel mechanism is independent of the mounting plate. Therefore the brake pedal is always in the same position.



BETTER MOBILITY. BETTER LIFE.



Picture may differ from original product

Technical Data

Wheel diameter	200 mm
Wheel width	46 mm
Caster width	99 mm
Plate size	176 x 112 mm
Plate hole centers	105 x 77,5 mm
Plate hole	13 mm
Dome-Ø	96 mm
Offset	55 mm
Swivel Interference	287 mm
Overall height	240 mm
Temperature	- 20 / + 80 °C
Standard	EN 12532
Weight	3.133 kg
Swivel Radius	143.5 mm
Hardness of tread	Shore A 63
Load capacity (dynamic)	300 kg
Load capacity (static)	600 kg

Dimensions

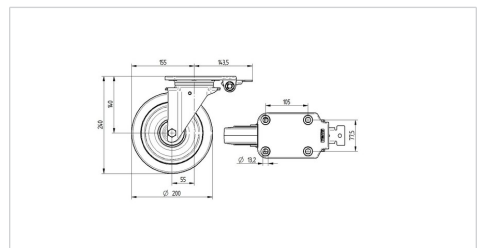

Structure & Mounting

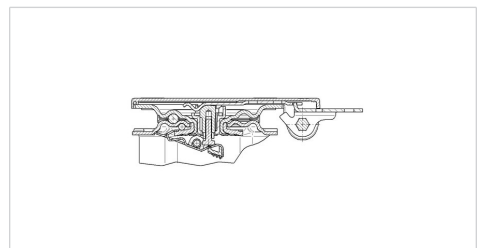

Advantages at a glance

Roll performance	● ● ● ○ ○
Movement noise	● ● ● ● ●
Attrition	● ● ● ○ ○
Corrosion resistance	● ● ● ○ ○

ALPHA

3476UFP200P67

EAN 4031582305012



BETTER MOBILITY. BETTER LIFE.

Structure & Mounting

