



BETTER MOBILITY. BETTER LIFE.

Foot Protection Ø160

EAN 4031582439038

Flexible foot protection for maximum occupational safety; suitable for use with our 3640, 4680, 9650 and 9680 housing ranges, as fixed, swivel or locking castor models.



Picture may differ from original product

Технические характеристики

| | |
|-------------------------|------------------------|
| Температура | -20 / +60 °C |
| Вес | 0.67 кг |
| Suitable wheel sizes | 160 мм |
| Длина | 220 мм |
| ширина | 151 мм |
| Ground clearance | 20 мм |
| Hardness of rubber flap | A 75 твердость по Шору |

Dimensions

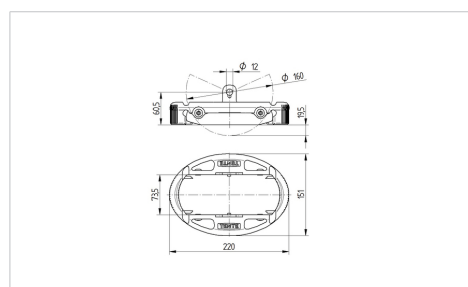

Advantages at a glance

| | |
|------------------------|-----------|
| Качество качения | ○ ○ ○ ○ ○ |
| Шум движения | ○ ○ ○ ○ ○ |
| Трение | ● ● ● ○ ○ |
| Коррозионная стойкость | ● ● ● ○ ○ |